

RS9100 Series

Optical Encoder

Data Sheet

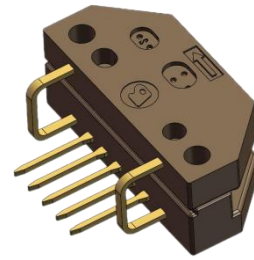

Description

RS9100 series are two channel optical incremental encoder modules. The module consists of a lensed LED source and a detector IC in a small plastic package. Due to a high collimated light source and a precision photodetector array, with a matched codewheel or codestrip, the module provides the information of rotary motor.

RS9100 series have lots of LPI options, standard LPIs : 45,90,120,150,180,254, 300, 360,450.

Features

- Photodetector Array
- -40 °C~ +100 °C Operating Temperature
- Resolution Up to 450 LPI
- C-Shape Structure, Easy to Mount
- No Signal Adjustment Required
- TTL Compatible
- Single 5V Supply

Applications

Printers, Plotters, Servo Motor, Factory Automation.

Note: Not recommend for use in life safety applications

Absolute Maximum Ratings

Parameter	Symbol	Range
Storage Temperature	T_s	-40 °C~ +100 °C
Operating Temperature	T_A	-40 °C~ +100 °C
Supply Voltage	V_{cc}	-0.5 ~ 7 V
Output Voltage	V_o	-0.5 ~ V_{cc}
Response Frequency	f	200 KHz
Output Current per Channel	I_o	-1 ~ 5 mA

Recommended Operating Conditions

Parameter	Symbol	Range
Working Temperature	T_A	-40 °C~ +100 °C
Supply Voltage	V_{CC}	Ripple voltage <100mV 4.5V ~ 5.5V
Shaft Perpendicularity Plus Axial Play	V_{CC}	-0.25mm~ 0.25mm
Shaft Eccentricity Plus Radial Play	V_{CC}	0.04mm

Electrical Characteristics

All parameters over Recommended Range and Recommended Mounting Tolerances. Typical at 25° C.

Parameter	Symbol	Min.	Typ.	Max.	Units	Condition
Module Operation Current		20	25	40	mA	
Detector Operating Current	I_{CC}		8	15	mA	
Low Level Output Voltage	V_{OL}		0.2	0.4	V	Internal 2kΩ pull-up resistor
High Level Output Voltage	V_{OH}	2.4	4.5		V	Internal 2kΩ pull-up resistor
A/B Rise Time	t_r		120		ns	Internal 2kΩ pull-up resistor CL=8PF
A/B Fall Time	t_f		20		ns	Internal 2kΩ pull-up resistor CL=8PF
A/B Duty Cycle	D_t	40	50	60	%	
A/B Phase Difference	θ	60	90	120	°e	
Count Frequency	f			200	KHz	

Waveform Diagram

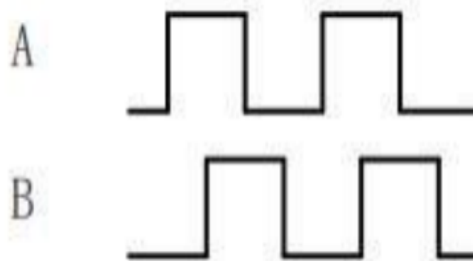

Fig.1 output waveform(in “ arrow ” direction)

Mechanical Dimension Drawing

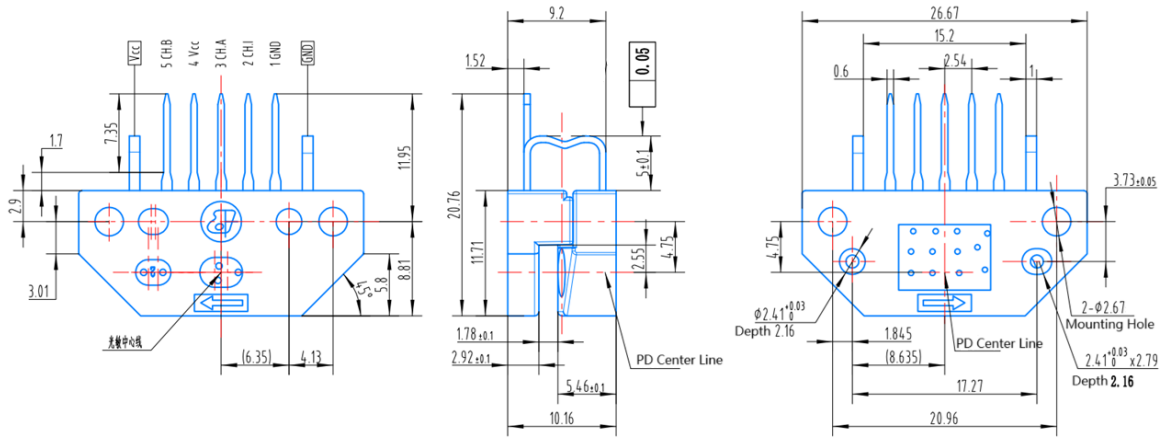

Fig.3 Mechanical Dimension

Pin Definitions

Pin Name	Description	Input/Output
Vcc	+ 5V	Power Supply
CH A	A Channel output	Output
CH B	B Channel output	Output
GND	Ground	Power Supply
NC	No connection	

Module Selections and Order Information

Two channel encoder modules with an 11mm Optical Radius.

RS 9 1 0 0 - □

CPR:		
C---100	E---200	F---256
G---360	H---400	A---500
B---1000		

Ordering Information

Two channel linear encoder module.

RS 9 1 00-□

LPI:	09 – 90LPI
45 – 45LPI	15 – 150LPI
12 – 120LPI	25 – 254LPI
18 – 180LPI	36 – 360LPI
30 – 300LPI	
F5 – 450LPI	

Module Printing

